



82-100 / 82A-140 SERIES

3-Piece Full Port Threaded Bronze Ball Valve

Job Name:	Contractor:
Job Location:	P.O. Number:
Engineer:	Representative:
Tag:	Wholesale Distributor:

DESCRIPTION

The Apollo® 82-100 Series is designed as an in-line serviceable full port bronze ball valve. SAE grade body bolts and RPTFE seals are standard.

FEATURES

- Dezincification Resistant Bronze Body
- Adjustable Packing Gland
- Blow-Out Proof Stem Design
- Premium RPTFE Seats and Seals
- Full Port Ball Configuration in all sizes
- Made in USA



PERFORMANCE RATING

- Maximum Pressure:
82-100 series: 600 psi CWP, 150 psi SWP
82A-140 series: 400 psi CWP, 150 psi SWP
- Maximum Temperature: 500°F
- Vacuum Service to 29 in. Hg

MODELS

- ☐ 82-100 Series Standard
- ☐ 82-140 Series 316 SS Ball & Stem
- ☐ 82A-140 Series 3" & 4" SS Trim Only

STANDARD MATERIALS LIST

Part Name	Material
Lever and Grip	Steel, Zinc Plated w/ Vinyl
Stem Packing	RPTFE
Stem Bearing	RPTFE
Ball	ASTM B16, Chrome Plated (1/4" - 2 1/2") ASTM A276-316 SS (3" - 4")
Seat (2)	RPTFE
End Cap (2)	B16 (1/4" & 3/8"), B584-C84400 (1/2" - 4")
Gland Nut	ASTM B16 Brass
Stem	ASTM B16, Chrome Plated (1/4" - 2 1/2") ASTM A276-316 SS (3" - 4")
Lever Nut	Steel, Zinc Plated
Body Bolt	Steel, Zinc Plated
Hex Nut	Steel, Zinc Plated
Body	B584-C84400 Bronze

DIMENSIONS

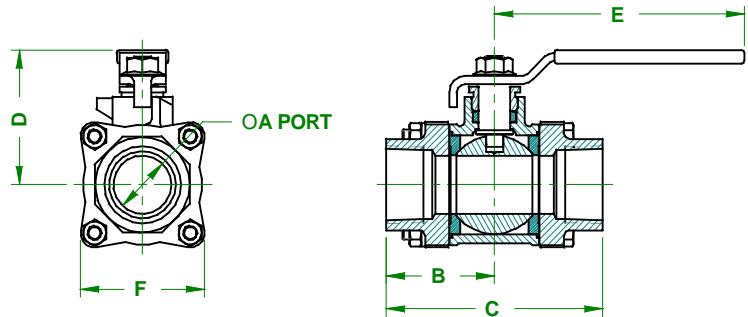

PART #	Size (in.)	Dimensions						Wt. (Lbs.)
		A	B	C	D	E	F	
82-101-01	1/4"	0.43	1.28	2.56	1.81	3.87	1.60	1.02
82-102-01	3/8"	0.50	1.28	2.56	1.81	3.87	1.60	1.04
82-103-01	1/2"	0.62	1.40	2.81	1.93	4.87	1.78	1.55
82-104-01	3/4"	0.81	1.71	3.43	2.18	4.87	1.98	2.27
82-105-01	1"	1.00	1.93	3.87	2.62	5.50	2.22	3.28
82-106-01	1 1/4"	1.25	2.37	4.75	2.87	5.50	2.70	5.62
82-107-01	1 1/2"	1.50	2.62	5.25	3.37	8.00	3.03	8.07
82-108-01	2"	2.00	3.01	6.03	3.68	8.00	3.87	14.42
82-109-01	2 1/2"	2.50	3.62	7.25	5.14	9.75	5.05	26.61
82A-140-01	3"	3.00	4.18	8.37	8.10	19.13	5.82	43.00
82A-14A-01	4"	4.00	5.43	10.86	8.88	19.13	7.77	106.00

APPROVALS

- MSS SP-10; Ball Valves, Threaded, Socket-Welding, Solder Joint, Grooved and Flared Ends
- CSA B51 CRN: OC10908.5C

Conbraco Industries, Inc. 701 Matthews Mint Hill Rd. Matthews NC 28106 USA; www.Apollovalves.com; 704-841-6000

This specification is provided for reference only. Conbraco reserves the right to change any portion of this specification without notice and without incurring obligation to make such changes to Conbraco products previously or subsequently sold.



82-100 / 82A-140 SERIES

3-Piece Full Port

Threaded Bronze Ball Valve

OPTIONS & SIZES

<input type="checkbox"/> (-01) Lever Handle (Standard)	1/4" - 4"
<input type="checkbox"/> (-02) Stem Grounded	1/4" - 4"
<input type="checkbox"/> (-03) 1 1/4" CS Stem Extension	1/4" - 2"
<input type="checkbox"/> (-04) 2 1/4" CS Stem Extension	1/4" - 2"
<input type="checkbox"/> (-07) Steel Tee Handle	1/4" - 2"
<input type="checkbox"/> (-08) 90° Reversed Stem	1/4" - 4"
<input type="checkbox"/> (-10) SS Lever & Nut	1/4" - 4"
<input type="checkbox"/> (-11) Therma-Seal® 2 1/4" Tee Handle	1/4" - 2"
<input type="checkbox"/> (-14) Side Vented Ball (Uni-Directional)	1/4" - 4"
<input type="checkbox"/> (-15) Wheel Handle, Steel	1/4" - 2"
<input type="checkbox"/> (-16) Chain Lever-Vertical	1/2" - 2"
<input type="checkbox"/> (-18) Plain Yellow Grip	1/4" - 2"
<input type="checkbox"/> (-19) Lock Plate	1/4" - 4"*
<input type="checkbox"/> (-20) Slot Vented Ball	1/4" - 4"*
<input type="checkbox"/> (-21) UHMWPE Trim (Non-PTFE)	1/4" - 4"
<input type="checkbox"/> (-23) Tank Flange	2" Only
<input type="checkbox"/> (-24) Graphite Packing	1/4" - 4"
<input type="checkbox"/> (-27) SS Latch-Lock Lever & Nut	1/2" - 2"
<input type="checkbox"/> (-30) Cam-Lock & Grounded	1/4" - 1 1/4"
<input type="checkbox"/> (-32) SS Tee Handle & Nut	1/4" - 2"
<input type="checkbox"/> (-35) PTFE Trim	1/4" - 4"
<input type="checkbox"/> (-39) SS Hi-Rise Locking Wheel Handle & Nut	1/4" - 1 1/4"
<input type="checkbox"/> (-40) Cyl-Loc & Grounded	1/4" - 1/2"
<input type="checkbox"/> (-45) Less Lever & Nut	1/4" - 4"
<input type="checkbox"/> (-46) Latch Lock Lever-Lock Closed Position Only	1/2" - 2"
<input type="checkbox"/> (-47) SS Oval Latch-Lock Handle & Nut	1/4" - 3/4"
<input type="checkbox"/> (-48) SS Oval Handle (No Latch) & Nut	1/4" - 2"
<input type="checkbox"/> (-49) Assembled Dry	1/4" - 4"
<input type="checkbox"/> (-50) 2-1/4" CS Locking Stem Extension	1/4" - 2"
<input type="checkbox"/> (-56) MPTFE Seats and Packing	1/4" - 4"
<input type="checkbox"/> (-57) Oxygen Cleaned	1/4" - 4"
<input type="checkbox"/> (-58) Chain Lever-Horizontal	3/4" - 2"
<input type="checkbox"/> (-59) SS External Trim	3/4" - 4"
<input type="checkbox"/> (-60) Static Grounded Ball & Stem	1/4" - 4"
<input type="checkbox"/> (-62) Body center section only	1/4" - 4"
<input type="checkbox"/> (-63) NPT x Solder	3/8" - 4"
<input type="checkbox"/> (-92) Balancing Stop	1/4" - 2"
<input type="checkbox"/> (-93) -03 Option & Balancing Stop	1/4" - 2"
<input type="checkbox"/> (-94) -04 Option & Balancing Stop	1/4" - 2"
<input type="checkbox"/> (-P01) BSPP (Parallel) Thread Connection	1/4" - 4"
<input type="checkbox"/> (-T01) BSPT (Tapered) Thread Connection	1/4" - 4"

* Options -19 & -20 are standard with 3 & 4" 82A-100 series